

**4½ x 4 - 4½ x 4½ - 4½ x 6 - 4½ x 7 - 4½ x 8
FULL MORTISE TEMPLATE HINGES**

DO NOT SCALE

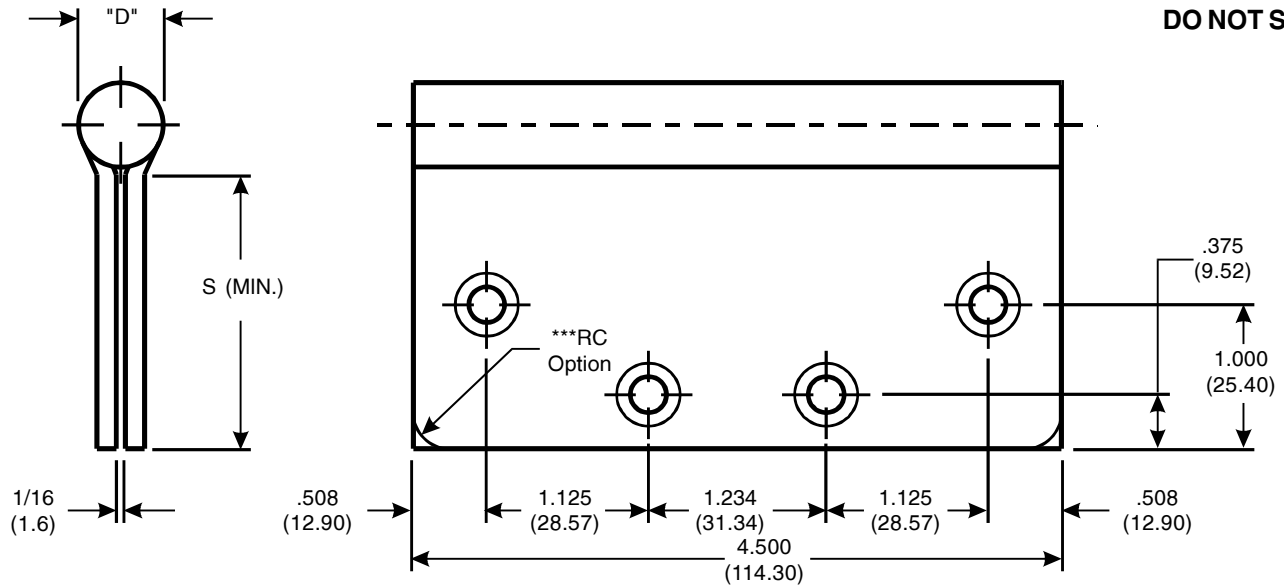

CATALOG NUMBER		GAUGE OF METAL	"D" OUTSIDE DIAMETER	"S" DISTANCE (SWAGE LINE)				
STEEL HINGES	*NON-FERROUS OR STAINLESS STEEL HINGES			HINGE WIDTH				
				4 (101.6)	4½ (114.3)	6 (152.4)	7 (177.8)	8 (203.2)
T 714	-	.134 (3.40)	.585 (14.86)	1-21/32 (42.1)	1-29/32 (48.4)	-	-	-
TA 714	TA 314	.134 (3.40)	.585 (14.86)	1-21/32 (42.1)	1-29/32 (48.4)	-	-	-
TA 786	TA 386	.180 (4.57)	.720 (18.29)	**	1-13/16 (46.0)	-	-	-
T 2714	T 2314	.134 (3.40)	.585 (14.86)	1-21/32 (42.1)	1-29/32 (48.4)	-	-	-
TCA 2714	TCA 2314	.134 (3.40)	.585 (14.86)	1-21/32 (42.1)	1-29/32 (48.4)	-	-	-
TA/TB 2714	TA/TB 2314	.134 (3.40)	.603 (15.32)	1-21/32 (42.1)	1-29/32 (48.4)	-	-	-
TA/TB 3713	TA/TB 3313	.134 (3.40)	.603 (15.32)	1-21/32 (42.1)	1-29/32 (48.4)	-	-	-
T 2731	-	.134 (3.40)	.525 (13.33)	1-11/16 (42.9)	1-15/16 (49.2)	-	-	-
TA 2731	TA 3331	.134 (3.140)	.525 (13.33)	1-11/16 (42.9)	1-15/16 (49.2)	-	-	-
TA/TB 2798	TA/TB 2398	.134 (3.40)	.603 (15.32)	-	-	2-21/32 (67.5)	3-5/32 (80.2)	3-21/32 (92.9)
TA 3750	TA 3350	.180 (4.57)	.701 (17.80)	**	1-13/16 (46.0)	-	-	-
TCA 3786	TCA 3386	.180 (4.57)	.752 (19.10)	**	1-13/16 (46.0)	2-9/16 (65.1)	3-1/16 (77.8)	3-9/16 (90.5)
T4A/T4B 3786	T4A/T4B 3386	.180 (4.57)	.752 (19.10)	**	1-13/16 (46.0)	2-9/16 (65.1)	3-1/16 (77.8)	3-9/16 (90.5)

McKINNEY Template Hinges of the above Catalog Numbers are made to conform to ANSI/BHMA 156.7.

Institutional Type Hinges conform to above screw hole locations.

Machine Screw Size - 1/2 x 12-24 F.H.

Wood Screw Size - 1-1/4 x 12 F. H.

*Check Catalog for Metals.

** Dimensions will be supplied upon request.

***Round Corner Option is available with 5/32(4.0), 1/4(6.3) & 5/8(15.9) radii, If none is specified 1/4(6.3) will be supplied.

McKINNEY Products Company

Manufacturer reserves the right to make changes without formal notice.