

**4" - 1502**  
**TEMPLATE FULL MORTISE CONCEALED BEARING**  
**ADJUSTABLE SPRING HINGE**

DO NOT SCALE

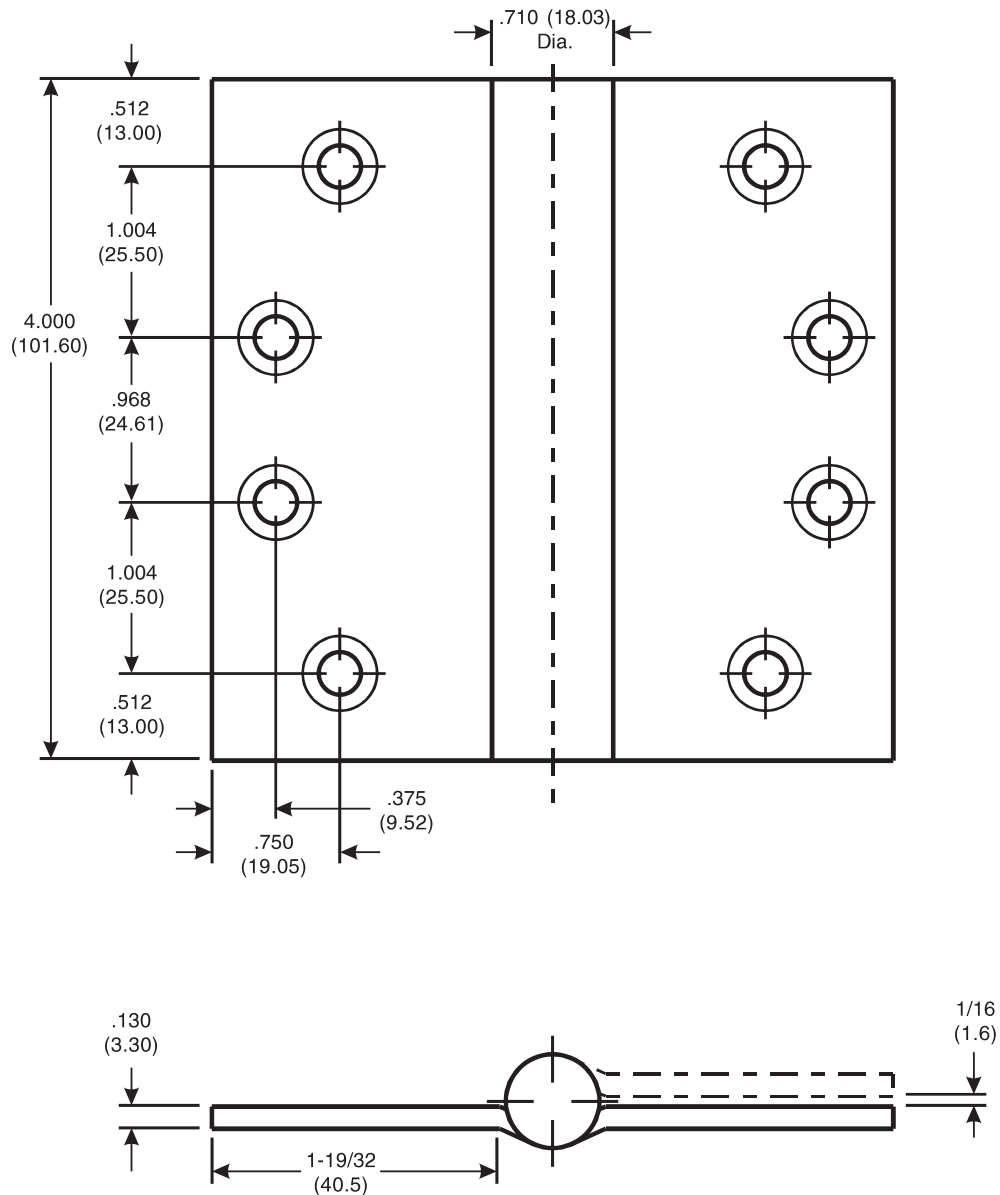

**TEMPLATE 535-98**

Copyright © 1998, 2008, McKinney Products Company, an ASSA ABLOY Group company. All rights reserved. Reproduction in whole or in part without the express written permission of McKinney Products Company is prohibited.

10/15/08

McKINNEY Template Full Mortise Concealed Bearing Adjustable Spring Hinges are made to conform to ANSI/BHMA 156.7.  
 Machine Screw Size - 1/2 x 12-24 F.H.  
 Wood Screw Size - 1-1/4 x 12 F. H.

McKINNEY Products Company • 225 Episcopal Road • Berlin, CT 06037 • PHONE: 800-346-7707 • FAX: 800-541-1073

ASSA ABLOY, the global leader in door opening solutions